

## 20"-24" INSTA-VALVE® 20-24

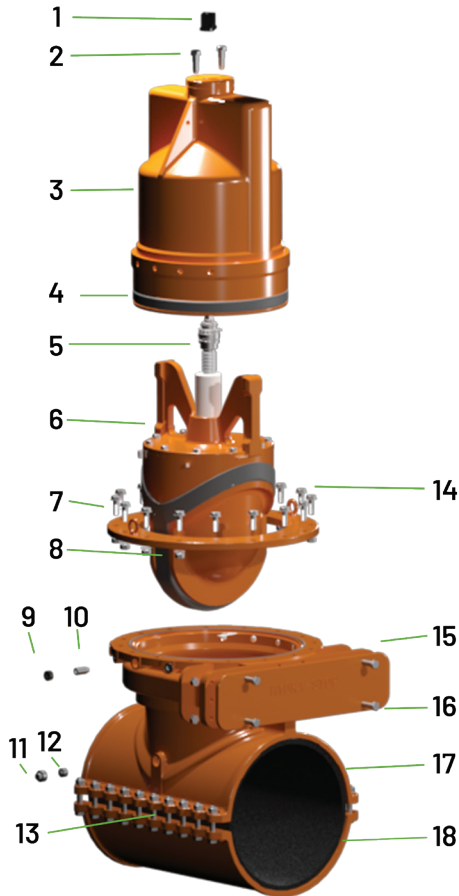

INSTA-VALVE 20-24 ASSEMBLY			
ITEM	DESCRIPTION	MATERIAL	QTY
1	OPERATING NUT	STEEL, CAST	1
2	BONNET COVER BOLTS	STAINLESS STEEL	4
3	BONNET COVER	DUCTILE IRON	1
4	SEAL RING	SBR RUBBER	1
5	FEED SCREW	STAINLESS STEEL	1
6	VALVE CARTRIDGE ASSEMBLY	VARIOUS	1
7	BONNET FLANGE	DUCTILE IRON	1
8	RESILIENT WEDGE	SBR RUBBER	8
9	SET PIN COVER PLUG	STEEL, S25C	20" VALVE: 6 24" VALVE: 8
10	SET PIN	STAINLESS STEEL	20" VALVE: 6 24" VALVE: 8
11	SEAL PLUG COVER	STAINLESS STEEL	1
12	SEAL PLUG	STAINLESS STEEL	1
13	VALVE MOUNTING HARDWARE (BOLTS, NUTS, WASHERS)	STAINLESS STEEL	20" VALVE: BOLTS: 18 NUTS: 18 WASHERS: 36  24" VALVE: BOLTS: 22 NUTS: 22 WASHERS: 44
14	BONNET FLANGE HARDWARE	STAINLESS STEEL	BOLTS: 16 NUTS: 16 WASHERS: 32
15	GATE VALVE COVER	DUCTILE IRON	1
16	GATE VALVE COVER BOLTS	STAINLESS STEEL	4
17	UPPER VALVE BODY	DUCTILE IRON	1
18	LOWER VALVE BODY	DUCTILE IRON	1

WEIGHTS AND DIMS					
Size	A	B	C	D	Approx. Weight
20"	35.5"	52.5"	32.5"	42"	2,228 lbs.
24"	39.5"	60.5"	36"	47"	3,139 lbs.

OTHER SPECIFICATIONS
Valve Body Minimum Test Pressure: 1.5 times system working pressure
Valve Body Maximum Test Pressure: 225 psi, Maximum Working Pressure: 150 psi
Coatings: Inside: 0.3 mm epoxy powder coating. Outside: 0.25 mm epoxy powder coating.
Valve ID Range: The ID range for the 20-inch insertion valve is 20.00"-20.82" and the 24-inch insertion valve's is 24.00"-24.89".
Valve OD Range: The OD range for the 20-inch insertion valve is 21.45"-22.25" and the 24-inch insertion valve's is 25.65"-26.47".

Proprietary Information: This property of Hydra-Stop shall not be used, reproduced, or distributed without written consent. All design and invention rights are reserved. Materials, pricing, and specifications subject to change without notice.

