

# Pricing and Order Information: How to purchase the Bevel Gear Actuator

1. Select the size of the gearbox you require.
2. Select the Insta-Valve 250 Valve Cartridge which meets your requirements. [Based on I.D. of pipe and open left or open right.]
3. Select the test flange [required for installation, but optional if already owned].
4. Select the Hydra-Core [required for installation, but optional if already owned].
5. **Place your order. 800-538-7867.**

**Step 1) Select the size of the gearbox you require. 4-8" or 10-12".**

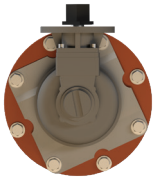

Nominal Size	Part Number	Description	List Price
4, 6, 8	7-BGKITLH-48	4-8" IV Bevel Gear Kit Assembly, LH	CALL
4, 6, 8	7-BGKITRH-48	4-8" IV Bevel Gear Kit Assembly, RH	CALL
10, 12	7-BGKITLH-1012	10-12" IV Bevel Gear Kit Assembly, LH	CALL
10, 12	7-BGKITRH-1012	10-12" IV Bevel Gear Kit Assembly, RH	CALL

Note: Kit comes with a valve box adapter which fits a 6.90 O.D. pipe (pipe and valve box lid are not included).

**Step 2) Select the gear box compatible Insta-Valve 250 Valve Cartridge which meets your requirements. [Based on I.D. of pipe and open left or open right.]**



**4"-12" INSTA-VALVE 250 OPEN LEFT VALVE CARTRIDGES (BLACK Operating Nut)**

Nominal Size	Valve Cartridge ID Range	Part Number	Description	List Price
4"	3.75+	25CARTLH04-250-BG	4" Open Left Cartridge, Bevel Gear	CALL
6"	5.75+	25CARTLH06-250-BG	6" Open Left Cartridge, Bevel Gear	CALL
	5.45-5.75	25CARTLH06-250-BG-U5.5	6" Open Left Cartridge, Bevel Gear Undersize	CALL
8"	7.80+	25CARTLH08-250-BG	8" Open Left Cartridge, Bevel Gear	CALL
	7.40-7.80	25CARTLH08-250-BG-U7.5	8" Open Left Cartridge, Bevel Gear Undersize	CALL
	7.40-7.80	25CARTLH08-250-BG-U7.5-AC	8" Open Left Cartridge, Bevel Gear Undersize AC	CALL
10"	9.70+	25CARTLH10-250-BG	10" Open Left Cartridge, Bevel Gear	CALL
	9.40-9.70	25CARTLH10-250-BG-U9.5	10" Open Left Cartridge, Bevel Gear Undersize	CALL
	9.40-9.70	25CARTLH10-250-BG-U9.5-AC	10" Open Left Cartridge, Bevel Gear Undersize AC	CALL
12"	11.70+	25CARTLH12-250-BG	12" Open Left Cartridge, Bevel Gear	CALL
	11.00-11.40	25CARTLH12-250-BG-U11.1	12" Open Left Cartridge, Bevel Gear Undersize	CALL
	11.40-11.70	25CARTLH12-250-BG-U11.5	12" Open Left Cartridge, Bevel Gear Undersize	CALL
	11.40-11.70	25CARTLH12-250-BG-U11.5-AC	12" Open Left Cartridge, Bevel Gear Undersize AC	CALL

Note: Gear box compatible valve cartridges include gearbox operating nut, gearbox feed screw. Undersized valve cartridges require the use of undersized cutters. See Hydra-Core Pipe Wall Sampling Kit operating instructions for reference. Undersized AC valve cartridges must be used in AC applications.

**Step 2 continued on next page.**



**Step 2 continued.**



**4"-12" INSTA-VALVE 250 OPEN RIGHT VALVE CARTRIDGES (RED valve stem cap)**

Nominal Size	Valve Cartridge ID Range	Part Number	Description	List Price
4"	3.75+	25CARTRH04-250-BG	4" Open Right Cartridge, Bevel Gear	CALL
6"	5.75+	25CARTRH06-250-BG	6" Open Right Cartridge, Bevel Gear	CALL
	5.45-5.75	25CARTRH06-250-BG-U5.5	6" Open Right Cartridge, Bevel Gear Undersize	CALL
8"	7.80+	25CARTRH08-250-BG	8" Open Right Cartridge, Bevel Gear	CALL
	7.40-7.80	25CARTRH08-250-BG-U7.5	8" Open Right Cartridge, Bevel Gear Undersize	CALL
	7.40-7.80	25CARTRH08-250-BG-U7.5-AC	8" Open Right Cartridge, Bevel Gear Undersize AC	CALL
10"	9.70+	25CARTRH10-250-BG	10" Open Right Cartridge, Bevel Gear	CALL
	9.40-9.70	25CARTRH10-250-BG-U9.5	10" Open Right Cartridge, Bevel Gear Undersize	CALL
	9.40-9.70	25CARTRH10-250-BG-U9.5-AC	10" Open Right Cartridge, Bevel Gear Undersize AC	CALL
12"	11.70+	25CARTRH12-250-BG	12" Open Right Cartridge, Bevel Gear	CALL
	11.00-11.40	25CARTRH12-250-BG-U11.1	12" Open Right Cartridge, Bevel Gear Undersize	CALL
	11.40-11.70	25CARTRH12-250-BG-U11.5	12" Open Right Cartridge, Bevel Gear Undersize	CALL
	11.40-11.70	25CARTRH12-250-BG-U11.5-AC	12" Open Right Cartridge, Bevel Gear Undersize AC	CALL

Note: Gear box compatible valve cartridges include gearbox operating nut, gearbox feed screw. Undersized valve cartridges require the use of undersized cutters. See Hydra-Core Pipe Wall Sampling Kit operating instructions for reference. Undersized AC valve cartridges must be used in AC applications.

**Step 3) Select the size of the test flange you require. 4-8" or 10-12".  
Required for installation, but optional purchase if already owned.**

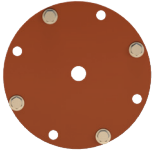

Nominal Size	Part Number	Description	List Price
4-8"	8TIPRSKT08-HP	4-8" Pressure Test Flange	CALL
10-12"	8TIPRSKT12-HP	10-12" Pressure Test Flange	CALL

**Step 4a) Select the base Hydra-Core Pipe Wall Sampling kit. Required for 6-12" installation, but optional purchase if already owned and not required for 4" installation. (Step 4 continues on next page.)**

Nominal Size	Part Number	Description	List Price
6-8"	7-COREKIT-68	Base kit includes: <ul style="list-style-type: none"> <li>• 6" Centering Ring</li> <li>• 8" Centering Ring</li> <li>• 2.5" Centering Tool</li> <li>• 6-8 Pilot Bit, 5/8" Diameter, Carbide</li> <li>• 6-8 Pilot Bit, 5/8" Diameter, Twist</li> <li>• Assembly Hardware</li> </ul>	CALL
10-12"	7-COREKIT-1012	Base kit includes: <ul style="list-style-type: none"> <li>• 10" centering ring</li> <li>• 12" centering ring</li> <li>• Centering Tool, 4" Diameter with Clips</li> <li>• Adaptor, 10-12 SM to 4-8 Cutter</li> <li>• Adaptor Body, 10-12 SM to 4-8 Cutter</li> <li>• 10-12 Pilot Bit, 5/8" Diameter, Carbide</li> <li>• 10-12 Pilot Bit, 5/8" Diameter, Twist</li> <li>• Assembly Hardware</li> </ul>	CALL



**Step 4b) Select the your cutters. Optional purchase if already owned.**

Nominal Size	Part Number	Description	Kit Price	List Price
6"	8CTSTHS5.5R	Cutter, 5.5" Dia	\$613	CALL
8"	8CTSTHS7.5R	Cutter, 7.5" Dia	\$863	CALL
10"	8CTSTHS9.5R	Cutter, 9.5" Dia	\$1,400	CALL
12"	8CTSTHS11.1R	Cutter, 11.1" Dia	\$2,000	CALL
12"	8CTSTHS11.5R	Cutter, 11.5" Dia	\$1,713	CALL

**Step 4c) Select the your saw mandrels. Optional purchase if already owned.**

Nominal Size	Part Number	Description	Kit Price	List Price
6-8"	8TS468SM41	TS8 Saw Mandrel 4", 6", 8"	\$464	CALL
10-12"	8TI112SM55-CORE	TI12 Saw Mandrel 10" & 12" W/ Set Pin Thru Hole	\$514	CALL
12"	8CTSTHS11.5R	Cutter, 11.5" Dia	\$1,713	CALL

**Step 5) Place your order. Call Hydra-Stop Inside Sales at 800-538-7867 to place your order.**

